

DOUBLE WINDOW SIGHT GLASSES DW12G and DW12SS

DESCRIPTION

The DW12 is a series of double window sight glasses specially designed for installation downstream of steam traps, to monitor their performance such as checking for live steam leakage or blockage. Such devices can also be used for monitoring flow conditions in other applications, particularly in pipelines with liquid medium.

MAIN FEATURES

Compact and cost-effective.
Double window design.
Borosilicate glass.

OPTIONS: Mica shield discs for use with steam.

USE: Condensate lines and others (see "Body limiting conditions" table).

AVAILABLE MODELS: DW12G – cast iron.
DW12SS – stainless steel.

SIZES: DN 15 to DN 150.

CONNECTIONS: Flanged EN 1092-1/-2 PN 16.

INSTALLATION: Horizontal or vertical installation.
See IMI.

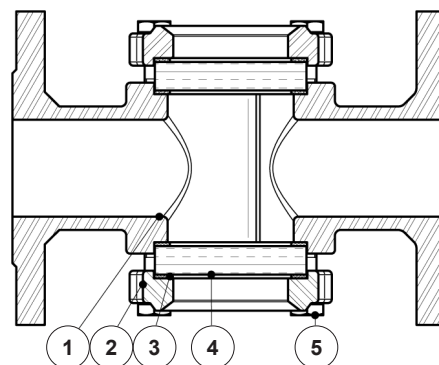
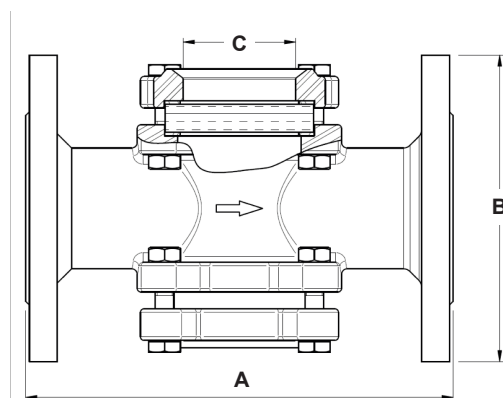

| CE MARKING – GROUP 2 (PED – European Directive) | |
|---|---------------|
| PN 16 | Category |
| DN 15 to DN 50 | SEP |
| DN 65 to DN 150 | 1 (CE marked) |

| BODY LIMITING CONDITIONS | | | |
|--------------------------|---------------------|---------------------|---------------------|
| DW12G * | | DW12SS | |
| ALLOWABLE PRESSURES | RELATED TEMPERATURE | ALLOWABLE PRESSURES | RELATED TEMPERATURE |
| 16 bar | -10 / 120 °C | 16 bar | -10 / 50 °C |
| 14,4 bar | 150 °C | 14,5 bar | 150 °C |
| 12,8 bar | 200 °C | 13,4 bar | 200 °C |
| 11,8 bar | 230 °C | 12,9 bar | 230 °C |
| 10,5 bar | 280 °C | 12,2 bar | 280 °C |

For applications with steam, use mica shield discs.

* Warning: The eventual use with steam/gas should be analyzed in accordance with the local applicable legislation, and always ensuring that there is no risk of water hammer.

| MATERIALS | | | |
|-----------|----------------|----------------------------|----------------------------|
| POS. N° | DESIGNATION | DW12G | DW12SS |
| 1 | Body | GJL-250 / 0.6025 | A351 CF8M / 1.4408 |
| 2 | Cover | GJL-250 / 0.6025 | A351 CF8M / 1.4408 |
| 3 | * Gasket | Stainless steel / Graphite | Stainless steel / Graphite |
| 4 | * Window glass | Borosilicate glass | Borosilicate glass |
| 5 | Bolts | Steel 8.8 | Stainless steel A2-70 |

* Available spare parts.

| DIMENSIONS (mm) | | | | | |
|-----------------|-----|-----|-----|-------------|--------|
| SIZE | A | B | C | WEIGHT (kg) | |
| | | | | DW12G | DW12SS |
| DN 15 | 130 | 95 | 44 | 3 | 3 |
| DN 20 | 150 | 105 | 44 | 3,5 | 4 |
| DN 25 | 160 | 115 | 44 | 4 | 5 |
| DN 32 | 180 | 140 | 50 | 6 | 6,5 |
| DN 40 | 200 | 150 | 50 | 6,5 | 7,3 |
| DN 50 | 230 | 165 | 60 | 9 | 10,5 |
| DN 65 | 290 | 185 | 90 | 17 | 17 |
| DN 80 | 310 | 200 | 90 | 18 | 20 |
| DN 100 | 350 | 220 | 110 | 23 | 26,5 |
| DN 125 | 400 | 250 | 142 | 50 | 52 |
| DN 150 | 480 | 285 | 160 | 63 | 68 |